

REFUSED

subject to the
requirements of the
associated Decision
Notice

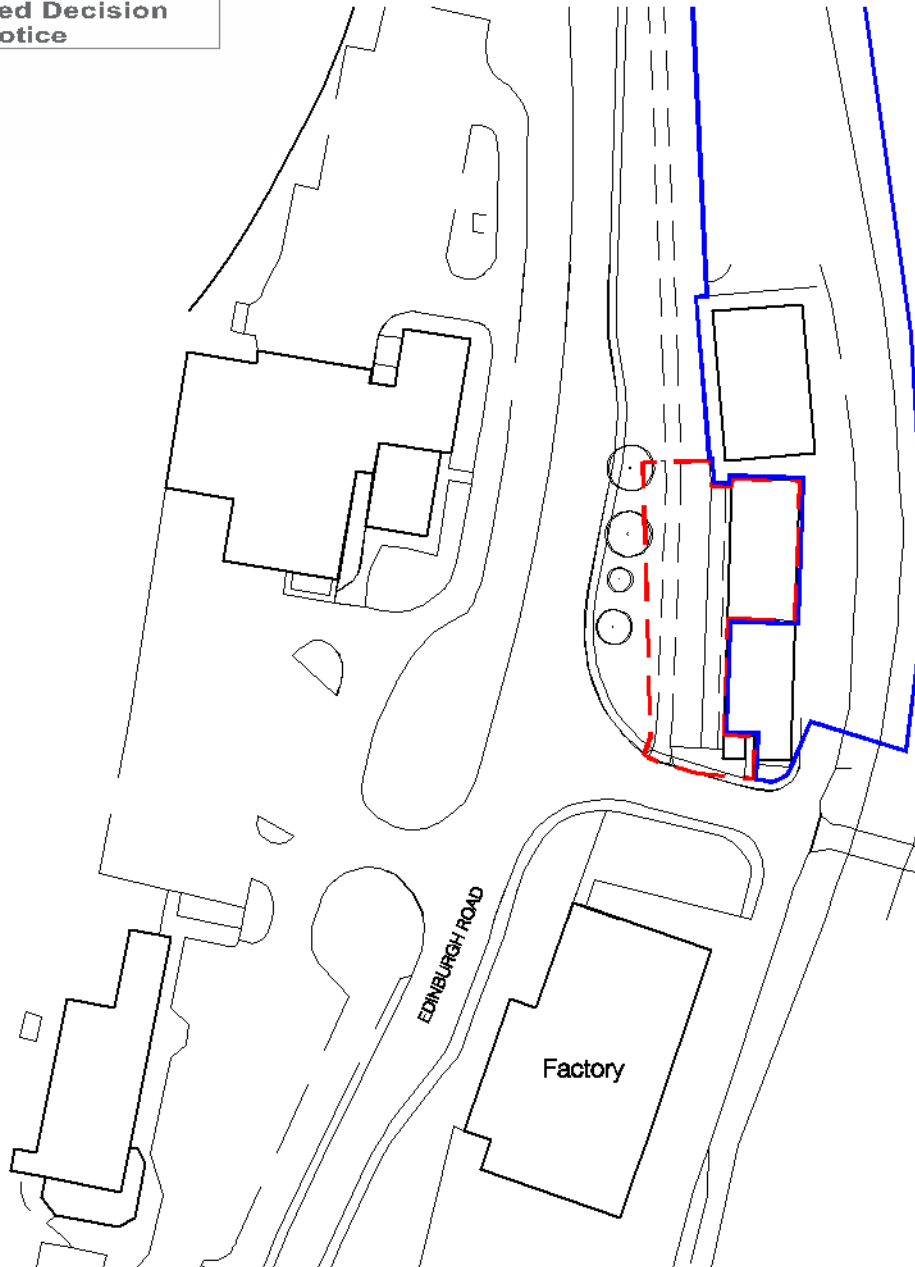

location plan
scale 1:1250

STUART DAVIDSON | ARCHITECTURE

CUSTOMER
Mr J Hewitt
PROJECT
Proposed formation of forecourt
Riverside Car Centre
Edinburgh road, Jedburgh
TITLE
Location Plan

DATE: Oct 2018 SCALE: as shown DWG NO: PM48-SK-L002 REVISION: D DCHY NO: 1 of 1 PLOTTED SCALE: A4
Design Studio, 35 High Street, Seaford, TN37 4DD TEL: 01753 217292
or info@stuartdavidsonarchitecture.co.uk www.stuartdavidsonarchitecture.co.uk © copyright reserved to stuart davidson architecture

FORECOURT AREA
existing grass + sub soil to be removed to continuous bearing sub soil level (gravel/clay) all to be well compacted + re-laid with type 1 hardcore laid on max 150mm layers compacted + cross rolled to create permeable bearing surface for new 80mm deep mixed size rounded riverbed gravel finish, all to be edges with treated 18mm wide timber edging board to separate from grassed areas

ACCESS TRACK
existing grass + sub base to be removed to continuous bearing sub soil level (gravel/clay) all to be well compacted + re-laid with type 1 hardcore laid on max 150mm layers compacted + cross rolled to create permeable bearing surface for new 80mm deep mixed size rounded riverbed gravel finish, all to be edges with treated 18mm wide timber edging board to separate from grassed and gravel areas

PAVEMENT CROSSING/DROP KERB
to be formed as shown to SBC technical Services specification, all works to be carried out by suitably SBC approved contractors kerbs to be dropped to provide clear vehicular transition between the existing road surface + access track, new drop kerbs + angled transition kerbs to be formed as shown with all re-finished in tarmac build up to SBC approval

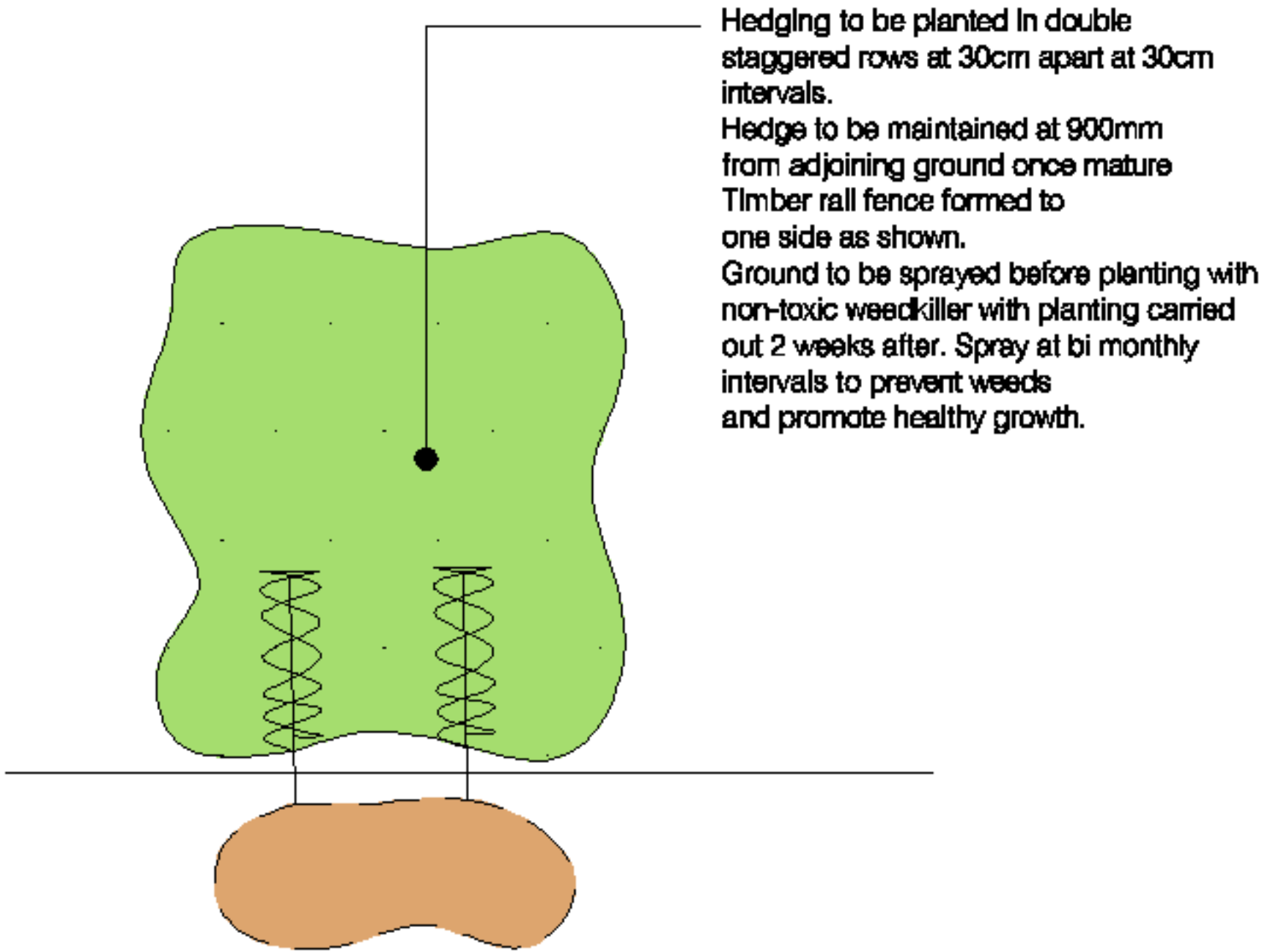

proposed hedge detail

scale 1:20

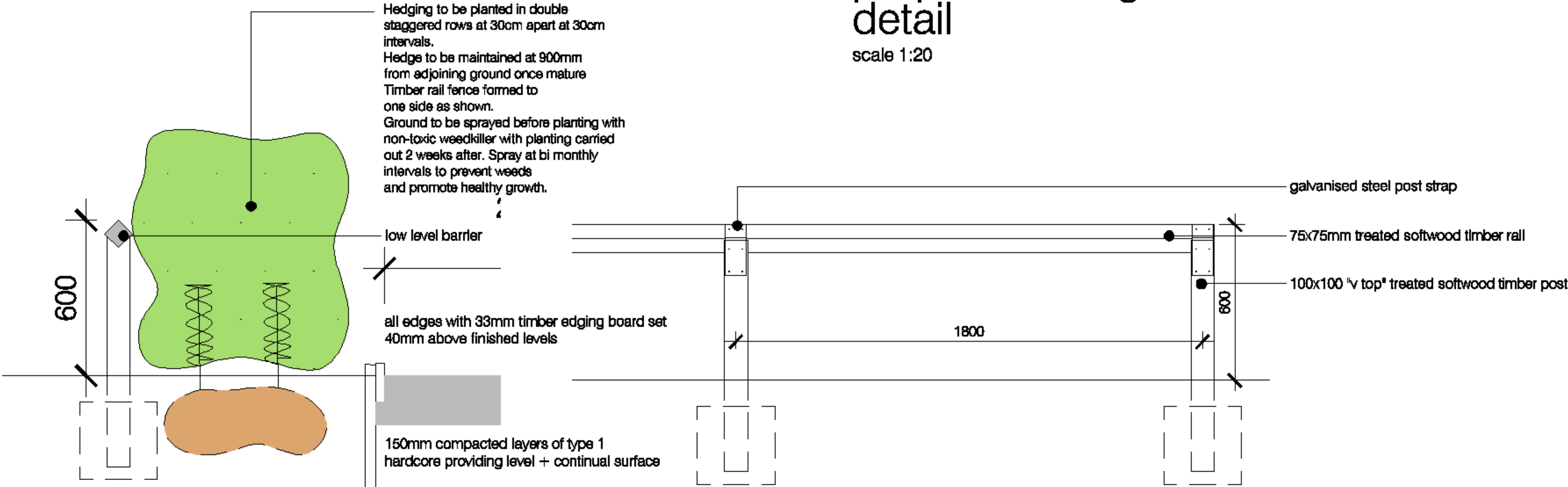

proposed fence detail

scale 1:20

proposed knee rail fence elevations

scale 1:20

Scottish Borders Council
Town And Country
Planning (Scotland) Act
1997

REFUSED

subject to the
requirements of the
associated Decision
Notice

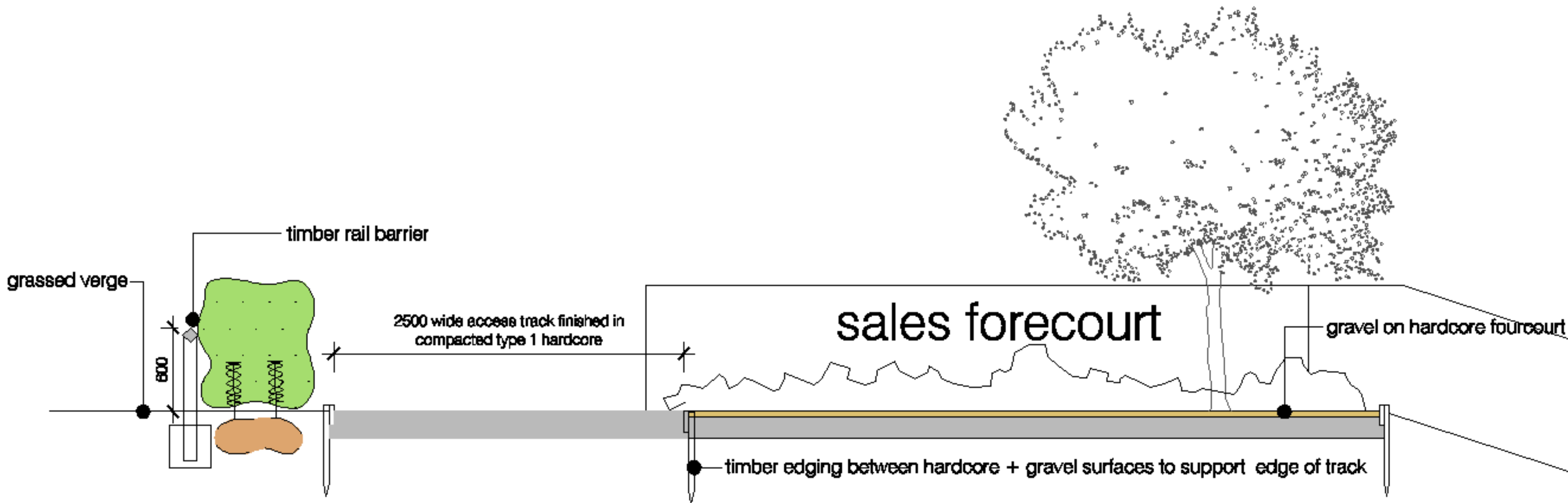

proposed site cross section

scale 1:50

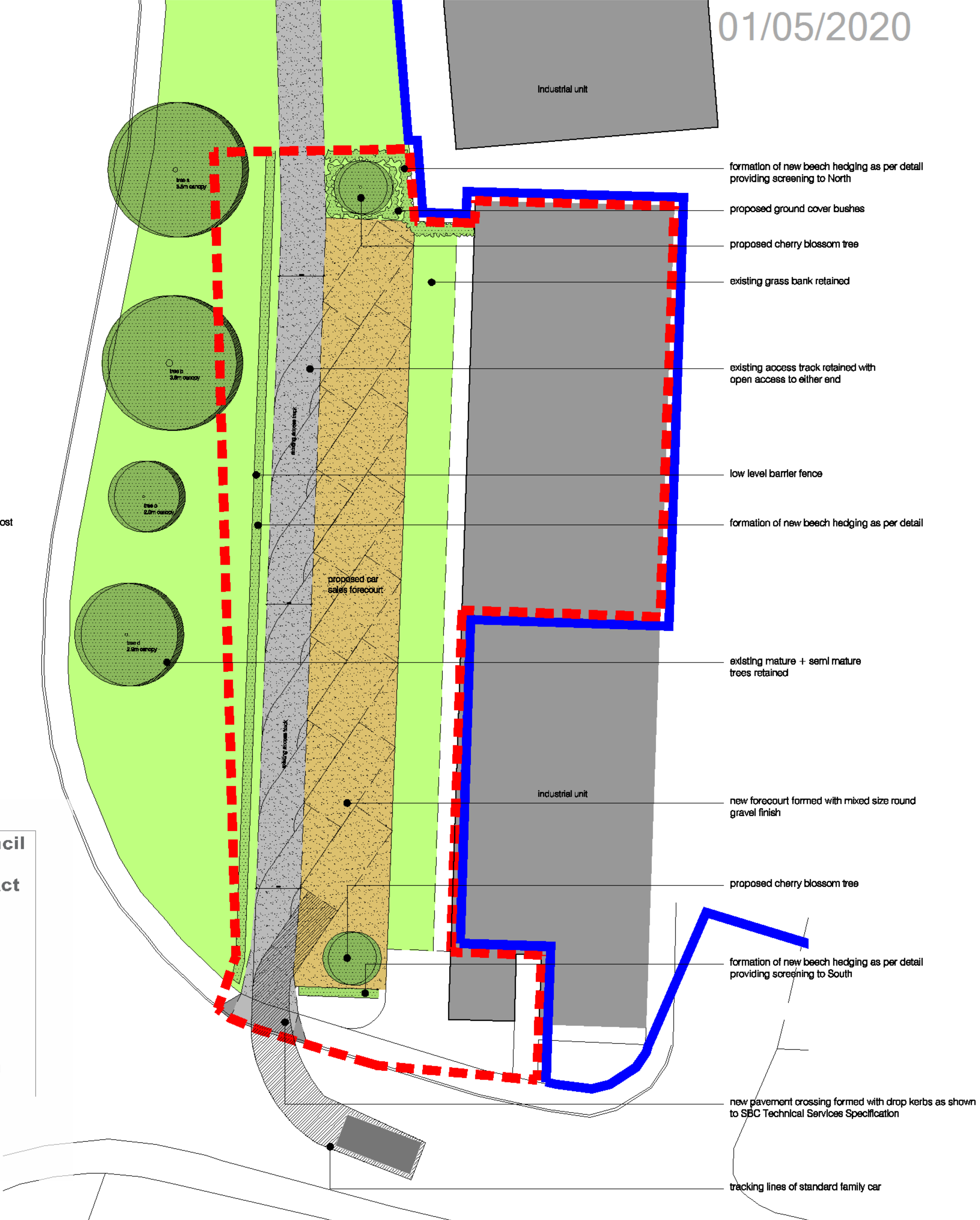

proposed block plan

scale 1:200

STUART DAVIDSON | ARCHITECTURE

CLIENT
Mr J Hewitt
PROJECT
Proposed formation of forecourt
Riverside Car Centre
Edinburgh road, Jedburgh
DATE: Oct 2018 SCALE: as shown DRAWN BY: SP-001 REVISION: H DRAWN BY: SP-001 PLOTTED SCALE: as shown
DATE: Oct 2018 SCALE: as shown DRAWN BY: SP-001 REVISION: H DRAWN BY: SP-001 PLOTTED SCALE: as shown
© copyright reserved to Stuart Davidson Architecture